

32 Lime Grove, Old Trafford, Trafford, M16 0NN



JP&Brimelow
ESTATE AGENTS

Offers In The Region Of £350,000

 3  2  2  D

VIDEO TOUR AVAILABLE A spacious & stylishly presented, THREE DOUBLE BEDROOM, semi-detached property. This period home is located on a quiet residential road in Old Trafford, off Seymour Grove. Ideally located for fantastic transport links, amenities, parks and schools and just a short distance to both Chorlton, Stretford and Manchester City centre. In brief the well-planned, bay fronted property consists of a welcoming entrance hall with useful shower room, a delightful lounge to the front aspect, a good-sized dining room with views and access out into the rear garden, a fitted kitchen, and a utility area completing this floor. To the first-floor landing there are three good sized double bedrooms and a contemporary white three-piece bathroom suite complete with free standing roll top bath. Other benefits include gas fired central heating, high ceilings, period features, stripped and varnished floor boards, and a rear enclosed garden. Internal inspection is highly recommended.





EPC Chart

Energy Efficiency Rating		
	Current	Potential
<i>Very energy efficient - lower running costs</i>		
(92 plus) A		
(81-91) B		84
(69-80) C		
(55-68) D	65	
(39-54) E		
(21-38) F		
(1-20) G		
<i>Not energy efficient - higher running costs</i>		
England & Wales	EU Directive 2002/91/EC 	



Tenure: **Leasehold** Council Tax Band: **B**

Ground Floor

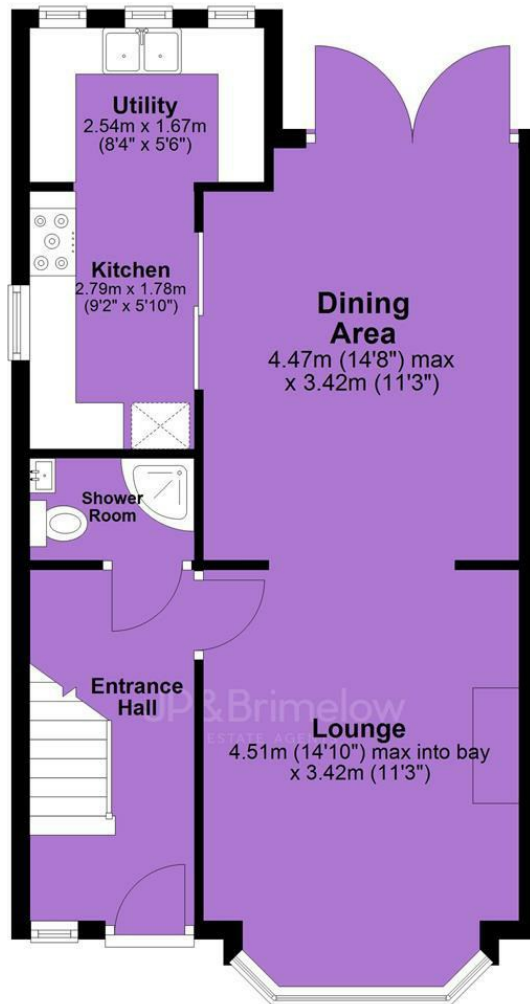

First Floor



JP & Brimelow Estate Agents Ltd
430 Barlow Moor Road, Manchester, M21 8AD
Tel: 0161 8822233
E: sales@jpbrimelow.co.uk www.jpandbrimelow.co.uk



JP & Brimelow
ESTATE AGENTS

NOTICE: JP & Brimelow Estate Agents Ltd for themselves and for the vendors or lessors of this property whose agents they are give notice that:

- (i) the particulars are set out as a general outline only for the guidance of intending purchasers or lessees, and do not constitute, nor constitute part of, an offer or contract;
- (ii) all descriptions, dimensions, references to the condition and necessary permissions for use and occupation, and other details are given in good faith and are believed to be correct but any intending purchasers or tenants should not rely on them as statements or representations of fact but must satisfy themselves by inspection or otherwise as to the correctness of each of them;
- (iii) no person in the employment of JP & Brimelow Estate Agents Ltd has any authority to make or give any representation or warranty whatever in relation to this property.

jpandbrimelowstateagents

@jpandbrimelow